

RCVCH-R | INTELLIGENT AIR QUALITY ROOM SENSOR

Mounting and operating instructions



Table of contents

SAFETY AND PRECAUTIONS	3
PRODUCT DESCRIPTION	4
ARTICLE CODE	4
INTENDED AREA OF USE	4
TECHNICAL DATA	4
STANDARDS	4
OPERATIONAL DIAGRAMS	5
WIRING AND CONNECTIONS	6
MOUNTING INSTRUCTIONS IN STEPS	6
OPERATING INSTRUCTIONS	9
VERIFICATION OF INSTALLATION	10
TRANSPORT AND STORAGE	10
WARRANTY AND RESTRICTIONS	10
MAINTENANCE	10

SAFETY AND PRECAUTIONS



Read all the information, the datasheet, Modbus map, mounting and operating instructions and study the wiring and connection diagram before working with the product. For personal and equipment safety, and for optimum product performance, make sure you entirely understand the contents before installing, using or maintaining this product.



For safety and licensing (CE) reasons, unauthorised conversion and /or modifications of the product are inadmissible.



The product should not be exposed to abnormal conditions, such as extreme temperatures, direct sunlight or vibrations. Long-term exposure to chemical vapours in high concentration can affect the product performance. Make sure the work environment is as dry as possible; avoid condensation.



All installations shall comply with local health and safety regulations and local electrical standards and approved codes. This product can only be installed by an engineer or a technician who has expert knowledge of the product and safety precautions.



Avoid contacts with energised electrical parts. Always disconnect the power supply before connecting, servicing or repairing the product.



Always verify that you apply appropriate power supply to the product and use appropriate wire size and characteristics. Make sure that all the screws and nuts are well tightened and fuses (if any) are fitted well.



Recycling of equipment and packaging should be taken into consideration and these should be disposed of in accordance with local and national legislation / regulations.



In case there are any questions that are not answered, please contact your technical support or consult a professional.

PRODUCT DESCRIPTION

The RCVCH-R are intelligent room sensors featuring adjustable temperature, relative humidity and TVOC ranges. The used algorithm controls a single analogue / modulating output based on the measured temperature, humidity and TVOC values, which can be used to directly control an EC fan, an AC fan speed controller or an actuator powered damper. They feature 24 VDC power supply and an ambient light sensor. All parameters are accessible via Modbus RTU.

ARTICLE CODE

Code	Supply	I _{max}	Connection
RCVCH-R	24 VDC	45 mA	RJ45 or terminal block

INTENDED AREA OF USE

- Demand controlled ventilation based on temperature, relative humidity and TVOC
- Suited for residential and commercial buildings
- For indoor use only

TECHNICAL DATA

- Spring contact terminal block or RJ45 connection
- Analogue / modulating output type:
 - ▶ 0–10 VDC mode: min. load 50 kΩ ($R_L \geq 50 \text{ k}\Omega$)
 - ▶ 0–20 mA: max. load 500 Ω ($R_L \leq 500 \Omega$)
 - ▶ PWM (open-collector type): PWM Frequency: 1 kHz, min. load 50 kΩ ($R_L \geq 50 \text{ k}\Omega$); PWM voltage level 3,3 VDC or 12 VDC
- Selectable temperature range: 0–50 °C
- Selectable relative humidity range: 0–100 % rH
- Selectable TVOC range: 0–60.000 ppb
- Warm-up time: 15 minutes
- Ambient light sensor with adjustable 'active' and 'standby' level
- Replaceable TVOC sensor module
- 3 LEDs with adjustable light intensity for status indication
- Accuracy: ±0,4 °C (0–50 °C); ±3 % rH (0–100 % rH); ±15% of measured TVOC (0–60.000 ppb), depending on the selected parameter
- Enclosure:
 - ▶ rear plate: plastic ABS, black (RAL 9004)
 - ▶ front cover: ASA, ivory (RAL 9010)
- Protection standard: IP30 (according to EN 60529)
- Operating ambient conditions:
 - ▶ temperature: 0–50 °C
 - ▶ rel. humidity: 0–95 % rH (non-condensing)
- Storage temperature: -10–60 °C

STANDARDS

- EMC directive 2014/30/EU:
 - ▶ EN 60730-1:2011 Automatic electrical controls for household and similar use - Part 1: General requirements
 - ▶ EN 61000-6-1:2007 Electromagnetic compatibility (EMC) - Part 6-1: Generic standards — Immunity for residential, commercial and light industrial environments



- ▶ EN 61000-6-3:2007 Electromagnetic compatibility (EMC) - Part 6-3: Generic standards – Emission standard for residential, commercial and light-industrial environments Amendments A1:2011 and AC:2012 to EN 61000-6-3
- ▶ EN 61326-1:2013 Electrical equipment for measurement, control and laboratory use - EMC requirements - Part 1: General requirements
- ▶ EN 61326-2-3:2013 Electrical equipment for measurement, control and laboratory use - EMC requirements - Part 2-3: Particular requirements – Test configuration, operational conditions and performance criteria for transducers with integrated or remote signal conditioning
- Low Voltage Directive 2014/35/EU
 - ▶ EN 60529:1991 Degrees of protection provided by enclosures (IP Code) Amendment AC:1993 to EN 60529
 - ▶ EN 60730-1:2011 Automatic electrical controls for household and similar use - Part 1: General requirements
- WEEE 2012/19/EU
- RoHs Directive 2011/65/EU

OPERATIONAL DIAGRAMS

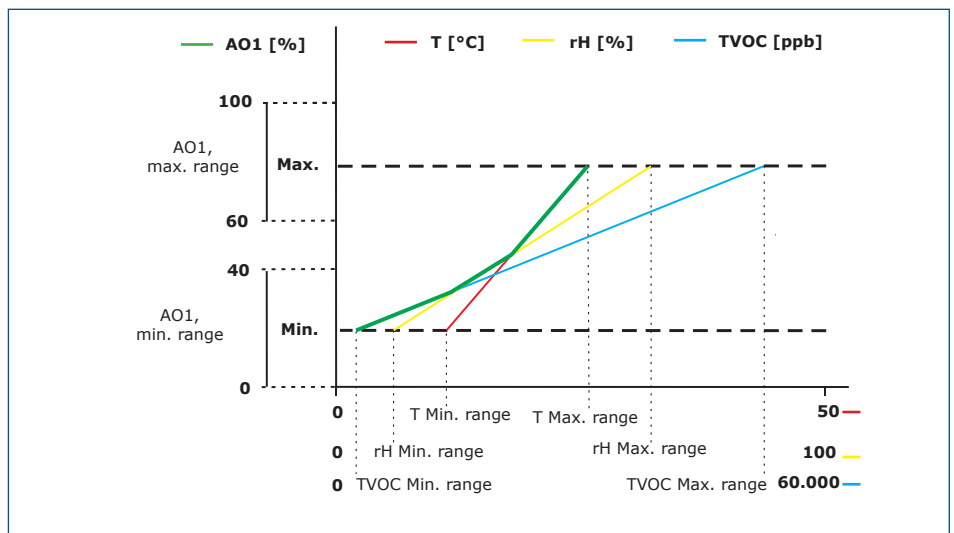

NOTE

The output changes automatically depending on the highest of the T, rH or TVOC values, i.e. the highest of the three output values controls the output. See the green line in the operational diagram above. One or multiple sensors can be deactivated. E.g. it is possible to control the output based on the measured TVOC value only.

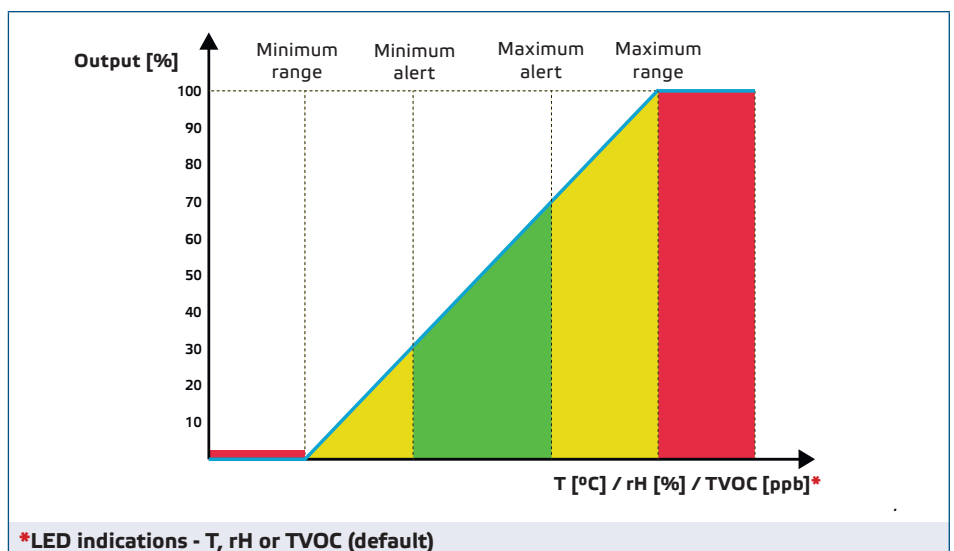

WIRING AND CONNECTIONS

RJ45 sockets (Power over Modbus)		
Pin 1	24 VDC	Supply voltage
Pin 2		
Pin 3	A	Modbus RTU communication, signal A
Pin 4		
Pin 5	/B	Modbus RTU communication, signal /B
Pin 6		
Pin 7	GND	Ground, supply voltage
Pin 8		

Terminal Block 1	
VIN	Supply voltage 24 VDC
GND	Supply voltage, ground
A	Modbus RTU communication, signal A
/B	Modbus RTU communication, signal /B

Terminal Block 2	
AO1	Analogue / modulating output (0–10 VDC / 0–20 mA / PWM)
GND	Ground AO1

ATTENTION

The unit needs to be supplied via the RJ45 connector or via the connection terminals. Do not connect the device via the RJ45 connector and the terminal block simultaneously!

MOUNTING INSTRUCTIONS IN STEPS

ATTENTION

Before you start mounting the unit, read carefully **“Safety and Precautions”**. Choose a smooth surface for installation (a wall, panel, etc.).

Mount the sensor in a well-ventilated area, where it receives adequate airflow for proper operation and hide it from direct sunlight. Make sure it can be easily accessed for service.

Follow these steps:

1. Using a flat screwdriver, remove the front white cover by releasing the snap-fits on both sides (see **Fig. 1 Snap-fits release**).
2. Insert the cables through the opening on the rear plate (see **Fig. 2 Mounting dimensions**.)
3. Using suitable fastening materials (not supplied), position the room sensor at least 1,5 m from the floor. Mind the correct mounting position and unit dimensions (see **Fig. 2** and **Fig. 3**).

Fig. 1 Snap-fits release

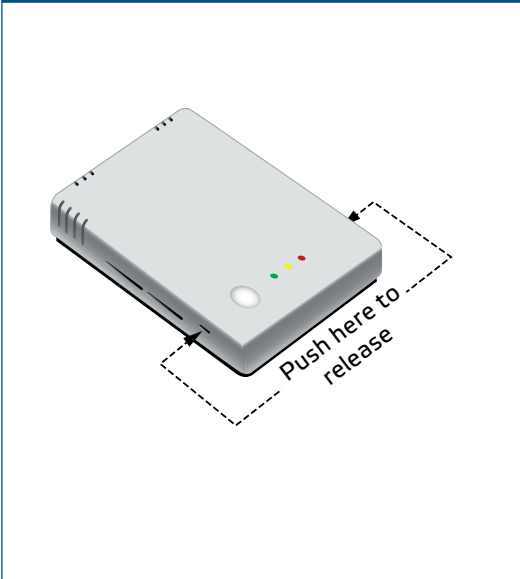

Fig. 2 Mounting dimensions

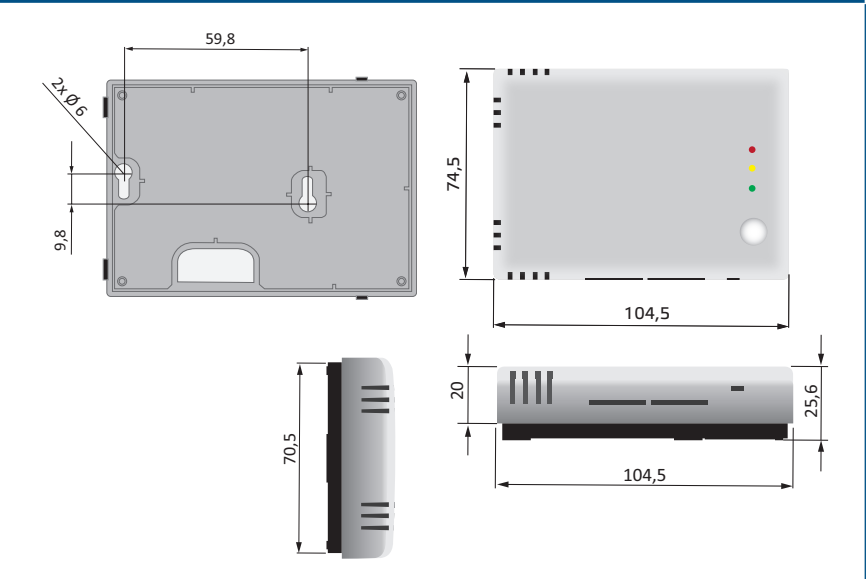
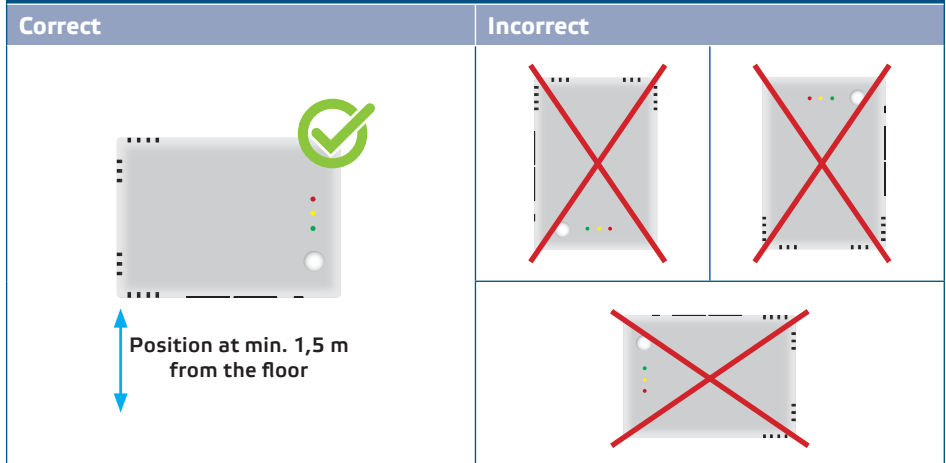
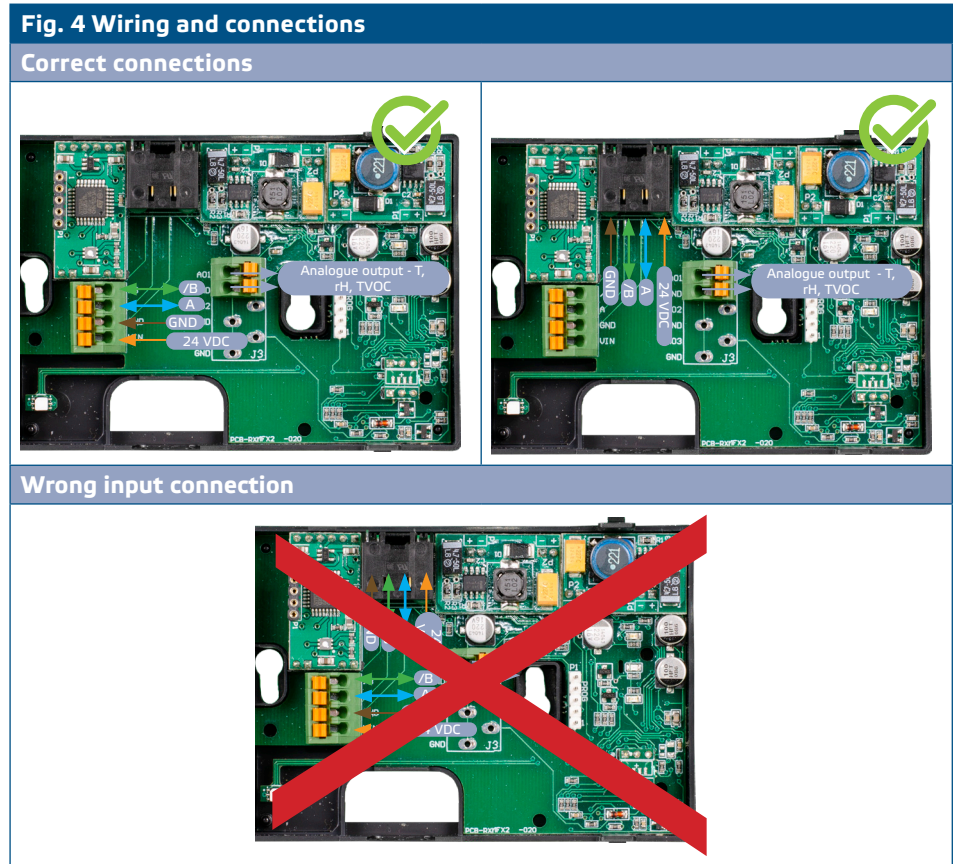

Fig. 3 Mounting position



4. Do the wiring according to the wiring diagram (see Fig. 4).



5. Put back the cover and snap it in.
6. Switch on the mains supply.
7. Customise the factory settings to the desired ones via the 3SModbus software or Sensistant (if necessary). For the default factory settings see the *Modbus register map* of the product.

NOTE

For the complete Modbus register data, see the Modbus Register Map of the product. This is a separate document linked to the article code on the website containing the list of registers. Products with earlier firmware versions may not be compatible with this list.

Optional settings

To assure correct communication, the NBT needs to be activated in only two devices on the Modbus RTU network. If necessary, enable the NBT resistor via 3SModbus or Sensistant (*Holding register 9*).

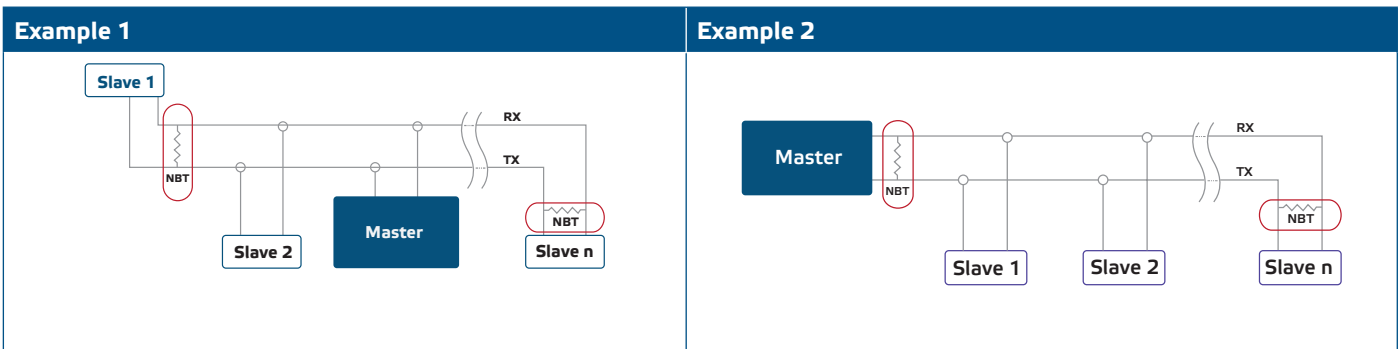

NOTE

On a Modbus RTU network, two bus terminators (NBTs) need to be activated.

NOTE

The sensor is not designed, manufactured or intended for control or monitoring equipment in environments requiring life safety performance, in which the failure of the sensor could lead directly to death, personal injury or severe physical or environmental damage.

OPERATING INSTRUCTIONS

NOTE

The compounds released from plastics may influence the sensor readings. Please allow several days for the sensor to stabilize before you obtain the accurate values.

NOTE

The warm-up time for the sensor to attain its highest accuracy and performance level once the voltage supply has been applied is 15 minutes. During the warm-up time the green LED is blinking and TVOC measurements will return 0 ppb.

Calibration procedure

All sensor elements are calibrated and tested in our factory. In the unlikely event of TVOC sensor element failure, this component can be replaced.

Firmware update

New functionalities and bug fixes are made available via a firmware update. In case your device does not have the latest firmware installed, it can be updated. SenteraWeb is the easiest way to update the firmware of the unit. In case you do not have an internet gateway available, the firmware can be updated via the 3SM boot application (part of the Sentera 3SMcenter software suite).

NOTE

Make sure the power supply does not get interrupted during "bootload" procedure.

LED indications

1. When the green LED is on, the measured value (temperature, relative humidity or TVOC) is between the minimum and maximum alert range values (**Fig. 5**).
2. When the yellow LED is on, the measured value (temperature, relative humidity or TVOC) is in the alert range (**Fig. 5**).
The yellow LED is blinking when the Modbus communication has stopped and HR8 is activated (Modbus timeout > 0 seconds).
3. When the red LED is on, the measured value (temperature, relative humidity or TVOC) is below the minimum measurement range value or above the maximum value. Blinking red LED indicates loss of communication with a sensor (**Fig. 5**).

NOTE

When the sensor is in bootloader mode, the green and yellow LEDs flash alternately. During the firmware download, the red LED is flashing additionally.

Fig. 5 LED indications

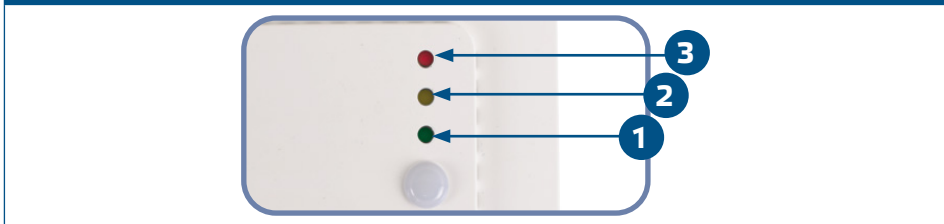



NOTE

By default, the LED indication refers to TVOC measurements. This can be changed to temperature or relative humidity values via Modbus Holding Register 79 (see Table Holding registers).



NOTE

The intensity of the LEDs can be adjusted between 0 and 100 % with a step of 10 % according to the value set in Holding register 80. Writing "0" in Holding register 80 turns OFF all LEDs.

Ambient light sensor

The measured light intensity in lux is available in Input Register 41. Additionally, an active and standby level can be defined in Holding registers 35 and 36. Input Register 42 indicates if the measured value is below standby level, above active level or in between both levels:

- Ambient light level < standby level: Input Register 42 indicates "Standby".
- Ambient light level > active level: Input Register 42 indicates "Active".
- Standby level < Ambient light level < Active level: Input Register 42 indicates "Low intensity".

VERIFICATION OF INSTALLATION

After switching on the power supply one of the LEDs lights up according to the status of the measured variable. If this is not the case, check the connections.

TRANSPORT AND STORAGE

Avoid shocks and extreme conditions; stock in original packing.

WARRANTY AND RESTRICTIONS

Two years from the delivery date against defects in manufacturing. Any modifications or alterations to the product after the date of publication relieve the manufacturer of any responsibilities. The manufacturer bears no responsibility for any misprints or mistakes in this data.

MAINTENANCE

In normal conditions this product is maintenance-free. If soiled, clean with a dry or damp cloth. In case of heavy pollution, clean with a non-aggressive product. In these circumstances the unit should be disconnected from the supply. Pay attention that no fluids enter the unit. Only reconnect it to the supply when it is completely dry.