

ADPT-SWCSM

Adapter box



ADPT-SWCSM is an adapter box for connecting SWCSM-075 soil water content sensor to a Sentera Modbus network.

Key features

- 24 VDC supply voltage, Power over Modbus (PoM)
- Socket for the Sentera soil moisture sensor type SWCSM-075 with M12 connector
- 2 RJ45 sockets for connecting to a Sentera network
- Power ON - Green LED indication
- Easy installation

Technical specifications

Input	2 sockets for RJ45 connector - Sentera PoM connection		
Output	Socket for 4 pole M12 connector - SWCSM-075 sensor		
Protection standard	Connector	IP67	
	Enclosure	IP65	
Ambient conditions	Temperature	-30—70 °C	
	Relative humidity	0—100 % rH	

Area of use

- Monitoring and control of environment and irrigation
- Measuring the moisture content of a medium
- Smart farming
- Agricultural applications to prevent overwatering

Standards

- WEEE 2012/19/EC
- RoHs Directive 2011/65/EC:
- EN IEC 63000:2018 Technical documentation for the assessment of electrical and electronic products with respect to the restriction of hazardous substances



Indications

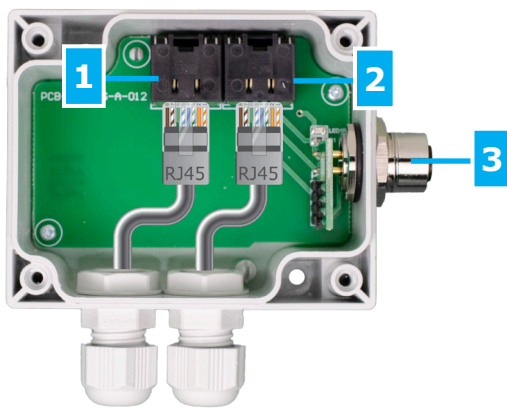

1 - RJ45 socket		Modbus RTU communication and 24 VDC power supply can be connected via the RJ45 sockets
2 - RJ45 socket		
3 - Socket for SWCSM-075		Plug in the Sentera soil moisture sensor cable

Attention! Connect the 24 VDC power supply to only one of the RJ45 sockets! Connecting two power supplies might result in short circuit!



Wiring diagram

RJ45 socket (Power over Modbus)

Pin 1	24 VDC	Supply voltage
Pin 2		
Pin 3	A	Modbus RTU communication, signal A
Pin 4		
Pin 5	/B	Modbus RTU communication, signal /B
Pin 6		
Pin 7	GND	Ground, supply voltage
Pin 8		



Fixing and dimensions

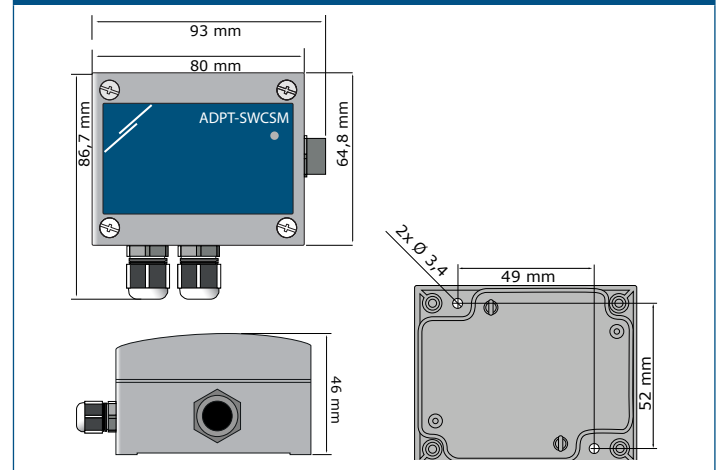

ADPT-SWCSM

Adapter box



Global trade item numbers (GTIN)

Packaging	ADPT-SWCSM
Unit	05401003017777

Packaging

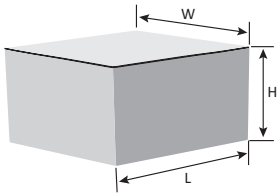

Article	Packaging	Length [mm]	Width [mm]	Height [mm]	Net weight	Gross weight
ADPT-SWCSM	Unit (1 pc.)	95	85	70	0,12 kg	0,16 kg

Application example

